

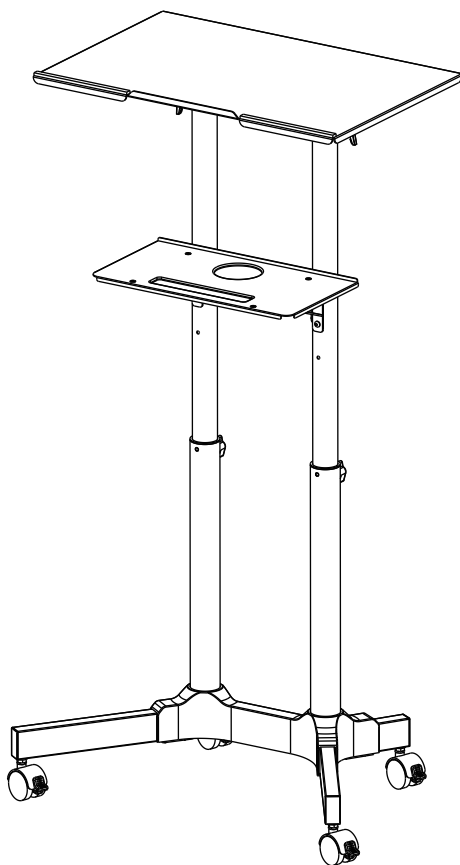

Assembly Instructions for Mobile Workstation

Model: MWS-001BK



Thanks for choosing our product. This stand ideally works as mobile podium, lectern and laptop workstation. The height of stand can be easily adjusted. The integrated wheels provide ease of movement.



Safety Warning: If you do not understand these directions, or have any doubts about the safety of the installation, please call a qualified contractor. Check carefully to make sure there are no missing or defective parts. Never use defective parts. Improper installation may cause damage or serious injury. Do not use this product for any purpose that is not explicitly specified in this manual. We can not be liable for damage or injury caused by incorrect mounting, incorrect assembly, or incorrect use.

Required Tools: Phillips screw driver.

Supplied Parts

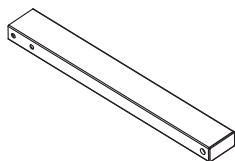

Long Square Tube
A (X2)

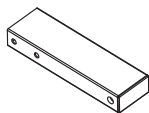

Short Square Tube
B (X2)



Wheel
C (X4)

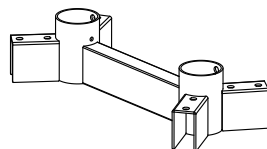

Tube Connector
D (X1)

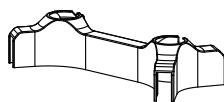

Tube Connector Cover
E (X1)

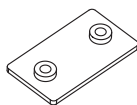

M6 Socket Plate
F (X4)

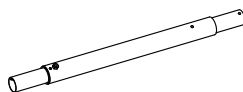

Pole Set
G (X2)



Plastic Sleeve
H (X4)

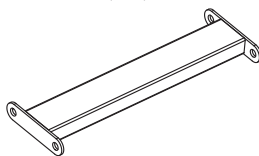

Connecting Tube
I (X1)

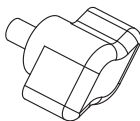

Plastic Knob
J (X2)

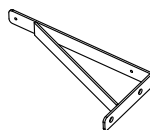

Shelf Support
K (X2)

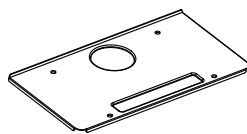

Shelf
L (X1)

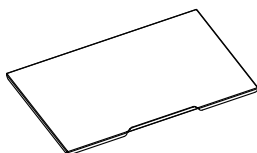

Top Plate
M (X1)

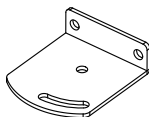

Right Connecting Plate
N (X1)

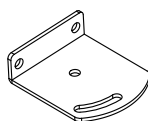

Left Connecting Plate
O (X1)



M6 Nut
P (X4)

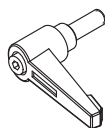

Lever
Q (X2)

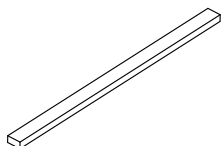

Soft Pad
R (X2)

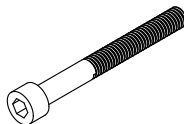

M6x60 Allen Head Bolt
S (X8)



M6x10 Allen Head Bolt
T (X12)



M4X6 Countersink Bolt
U (X4)



M5x6 Grub Screw
V (X2)



M6 Washer
W (X2)



3/32 in (2.5mm)
Small Allen Key
M-A (X1)



5/32 in (4mm)
Medium Allen Key
M-B (X1)

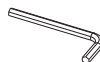

13/64 in (5mm)
Large Allen Key
M-C (X1)



Wrench
M-D (X1)

Step 1

Turn this nut to adjust
the height of wheel.

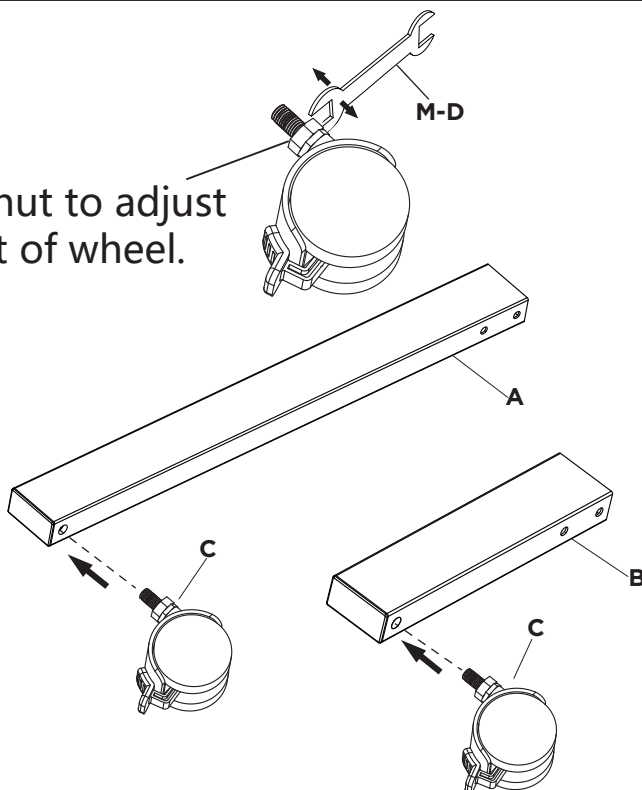

Step 2

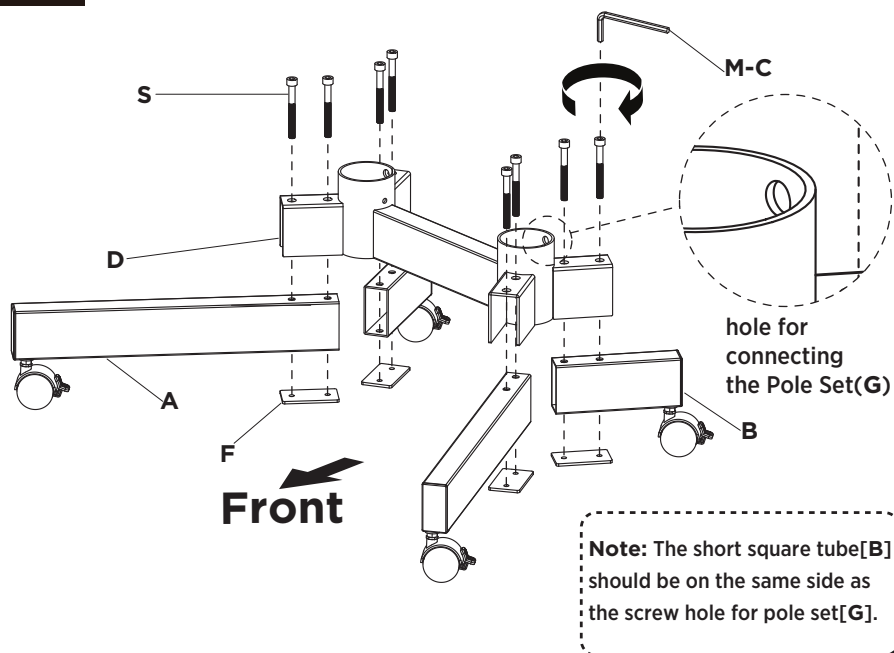

Step 3

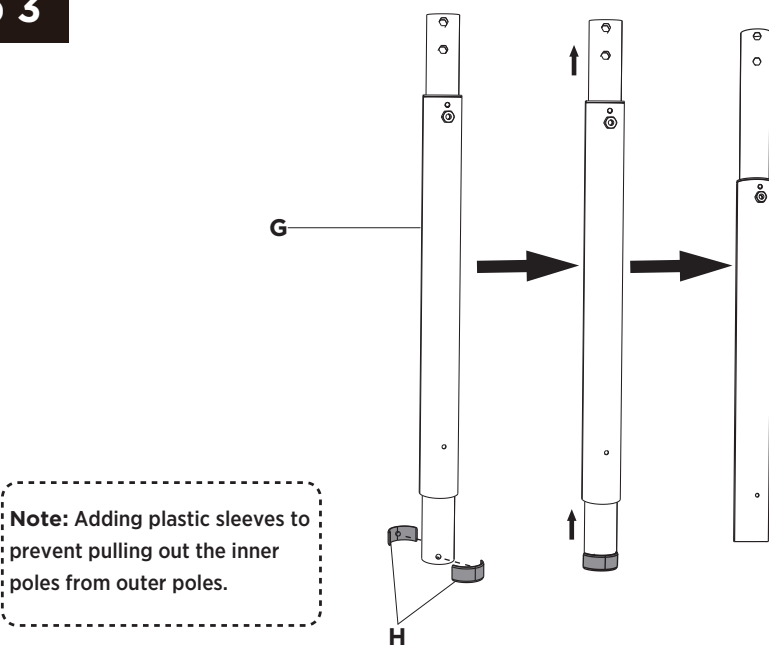

Step 4

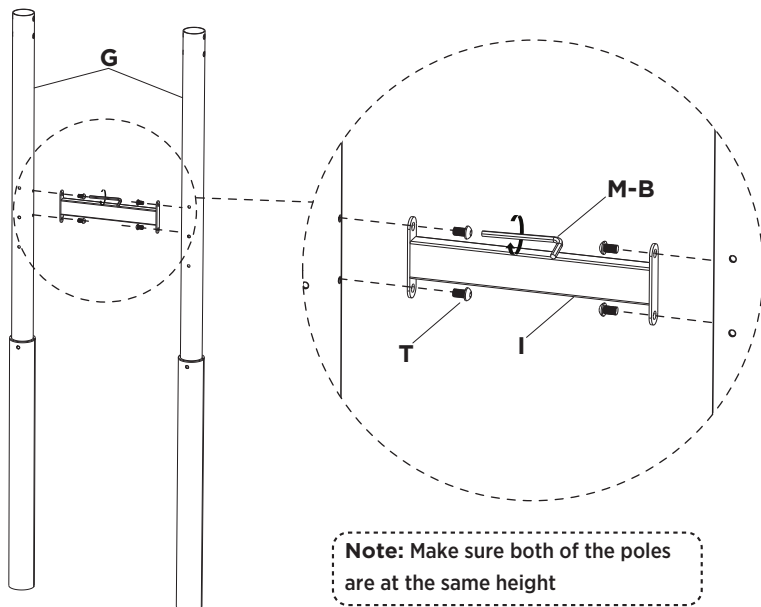

Step 5

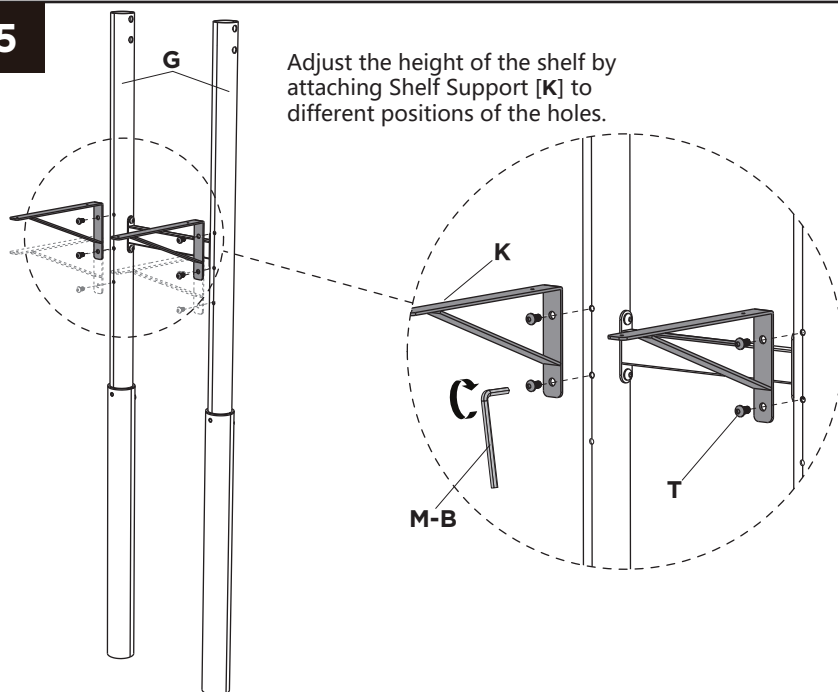

Step 6

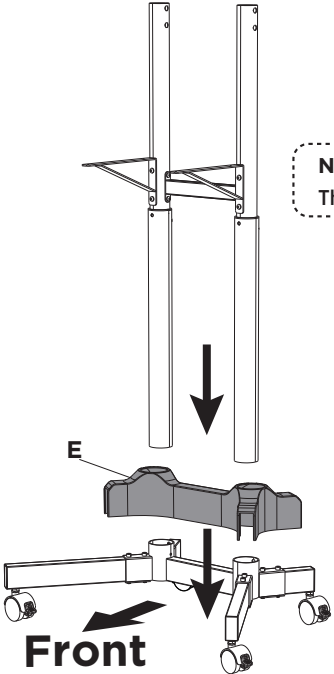

Note: The Shelf Supports, facing Them To The Long Square Tube

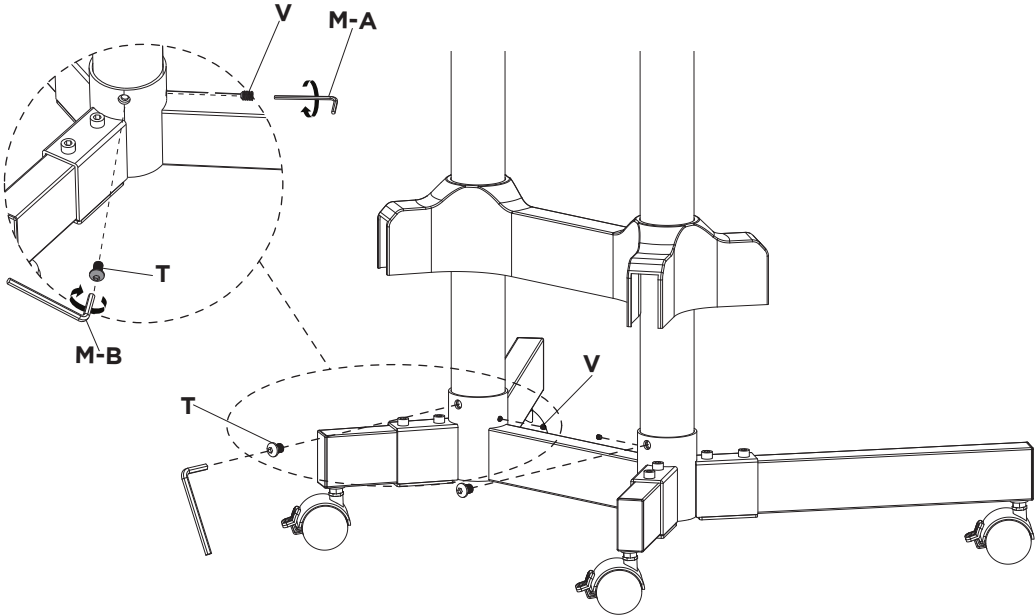

Step 7

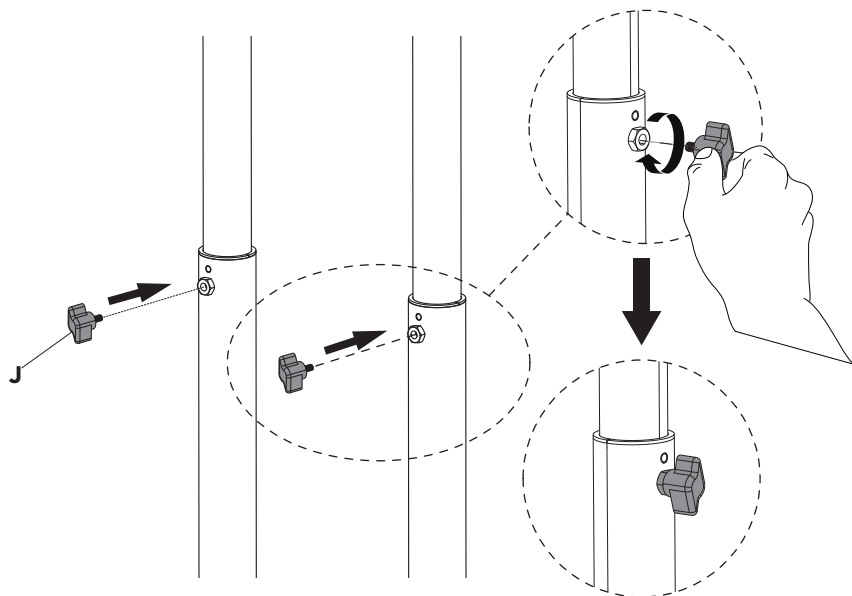

Step 8

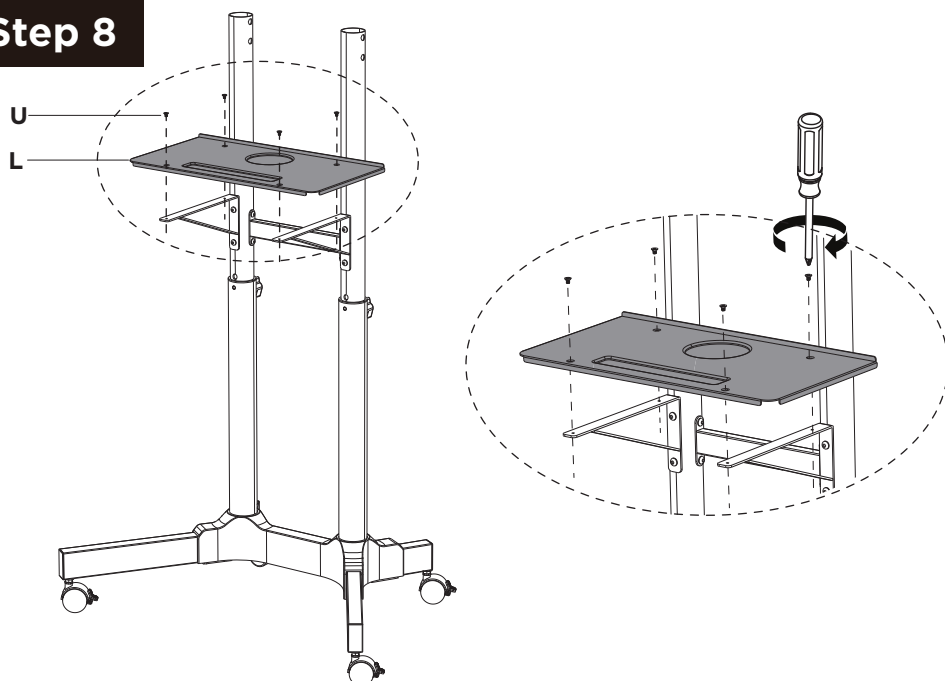

Step 9

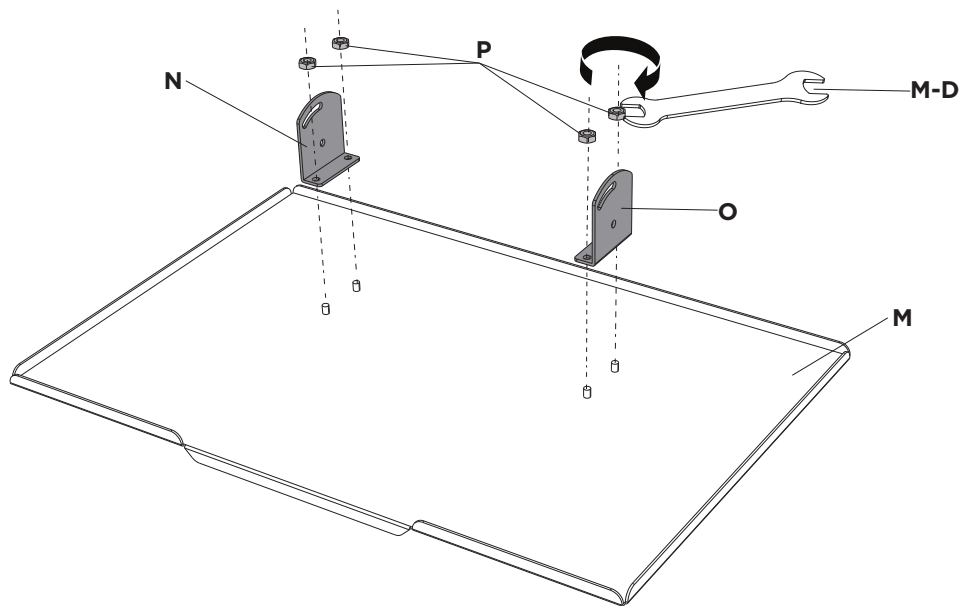

Step 10

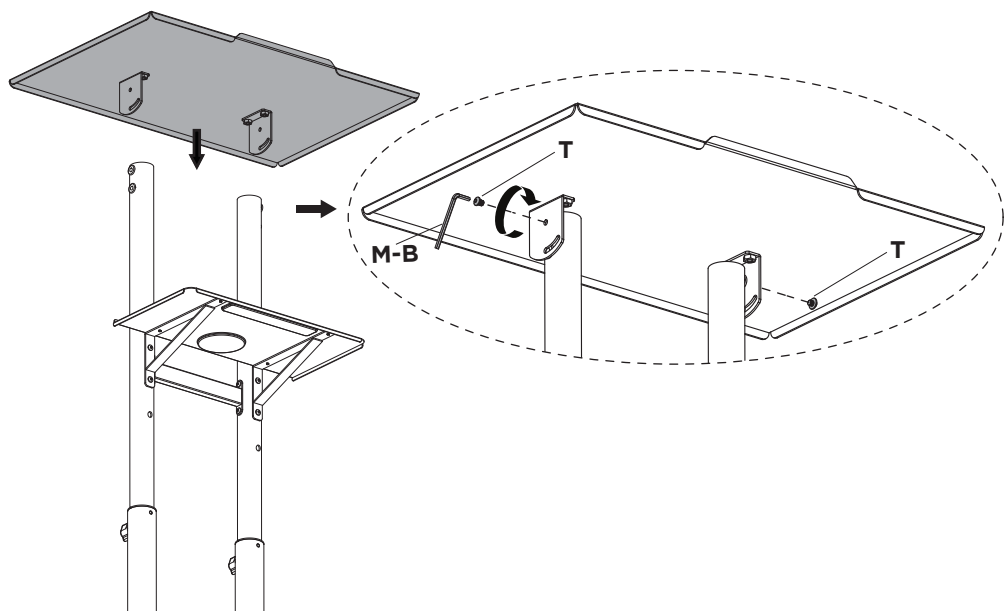

Step 11

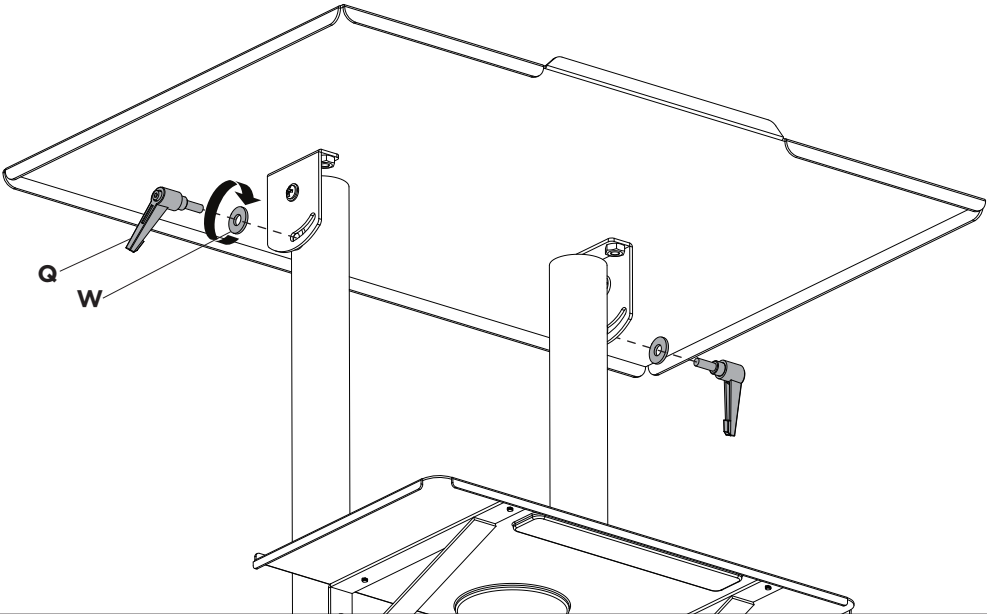

Step 12

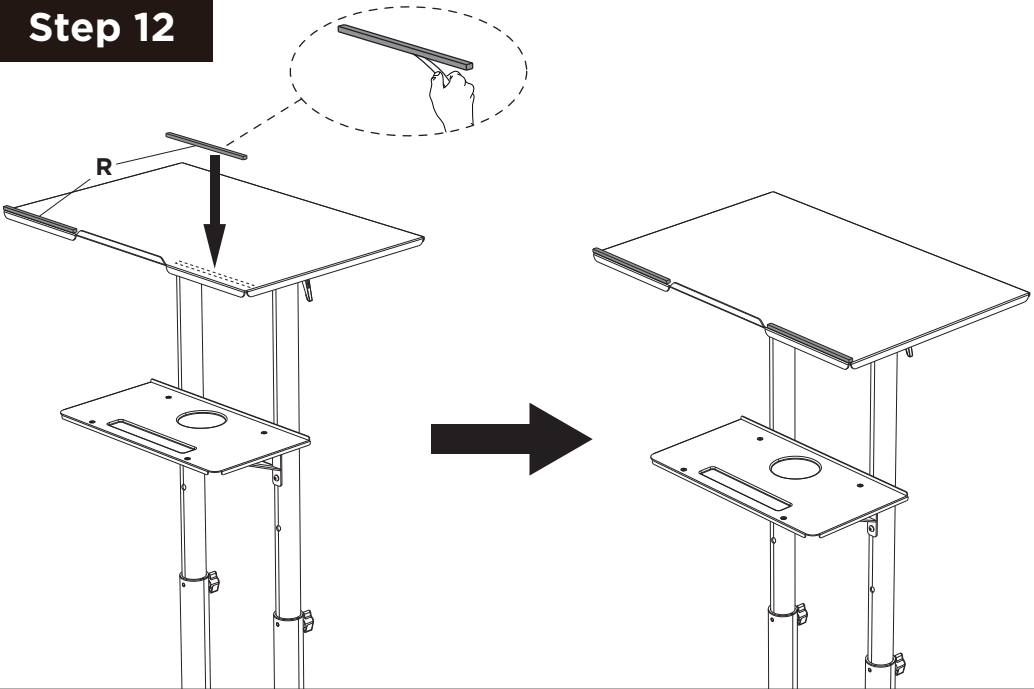

Step 13

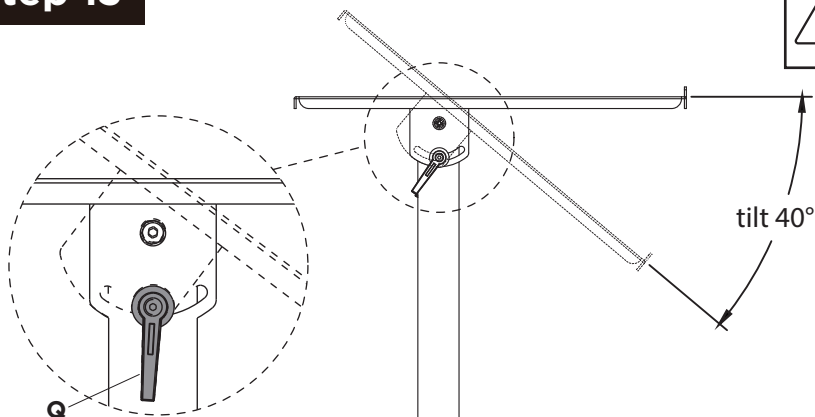

Tilt Adjustment

1. Slightly loosen the both levers [Q].
2. Tilt the top plate to your desired angle.
3. Re-tighten the both levers [Q] to secure the height in place.

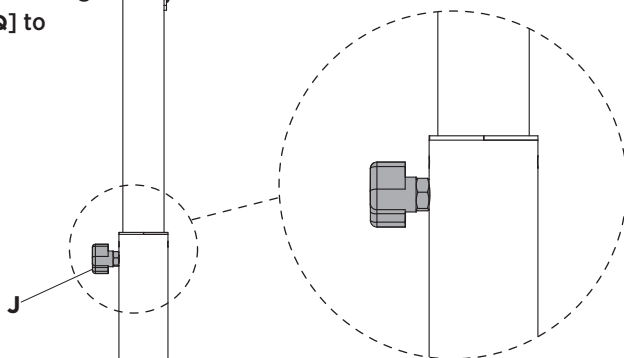

Height Adjustment

1. Slightly loosen the both knobs [J].
2. You may need two persons for assistance with this step. One person holds the both upper poles to adjust the height. The other person tightens the both knobs to secure the height.

Note: Please remove all items from the shelf prior to adjusting the height.

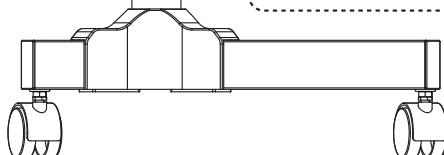

Step 13

