

BONTEC

INSTALLATION MANUAL

TV STAND

Model: FIT-2

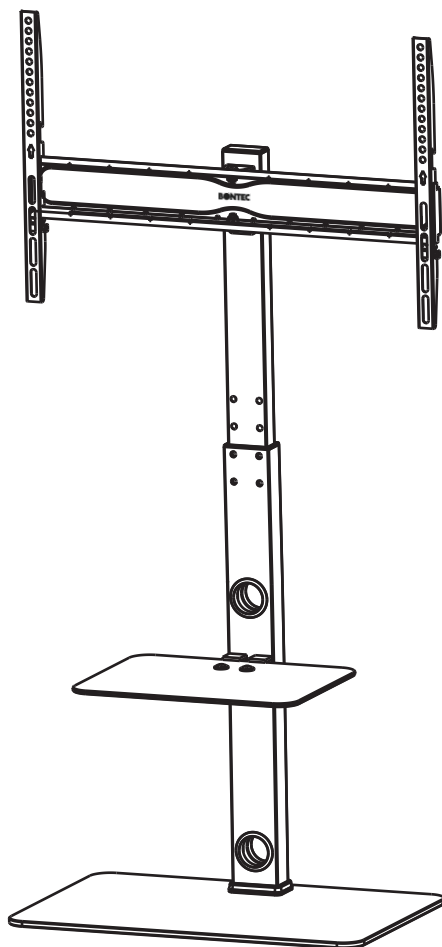

Thank you for choosing our products.

UNPACKING INSTRUCTIONS

- Carefully open the carton, remove contents and lay out on cardboard or other protective surface to avoid damage.
- Check package contents against the Supplied Parts List in the next page to assure that all components were received undamaged. Do not use damaged or defective parts.
- Carefully read all instructions before attempting installation.

IMPORTANT SAFETY INFORMATION

Install and operate this device with care. Please read this instruction before beginning the installation, and carefully follow all instructions contained herein. Use proper safety equipment during installation.

Please call a qualified installation contractor for help if you:

- If you don't understand these directions or have any doubts about the safety of the installation.
- If you are uncertain about the nature of your wall, consult a qualified installation contractor.

Do not use this product for any purpose or in any configuration not explicitly specified in this instruction. We hereby disclaim any and all liability for injury or damage arising from incorrect assembly, incorrect mounting, or incorrect use of this product.

COMPONENT CHECKLIST



A (X1)



B (X2)

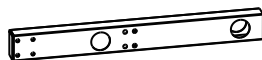

C (X1)



D (X1)



E (X1)

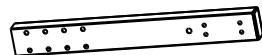

F (X1)

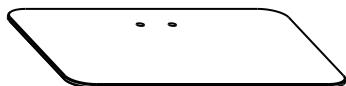

G (X1)

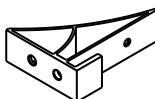

H (X2)

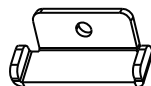

I (X2)
Safety Lock



J (X7)
M8x20x1
Plastic Washer

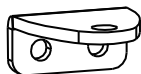

K (X2)



L (X2)
Wire Clip

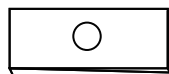

M (X2)

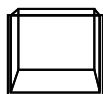

N (X6)
Rubber Foot



O (X8)
M8x50



P (X3)
M8x40



Q (X2)
M8x20



R (X4)
M6x40



S (X6)
M8



T (X4)
M6



U (X2)
M8x15



V (X3)
M8x22x2



W (X16)
M8x16x1



X (X2)
M5x30



Y1 (X1)
4mm



Y2 (X1)
5mm



Z1 (X1)
10mm



Z2 (X1)
13mm



W-A (X4)
M4x15



W-B (X4)
M4x30



W-C (X4)
M6x15



W-D (X4)
M6x30

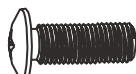

W-E (X4)
M8x15



W-F (X4)
M8x45



W-G (X4)
Washer



W-H (X8)
SP1



W-I (X8)
SP2

Step 1

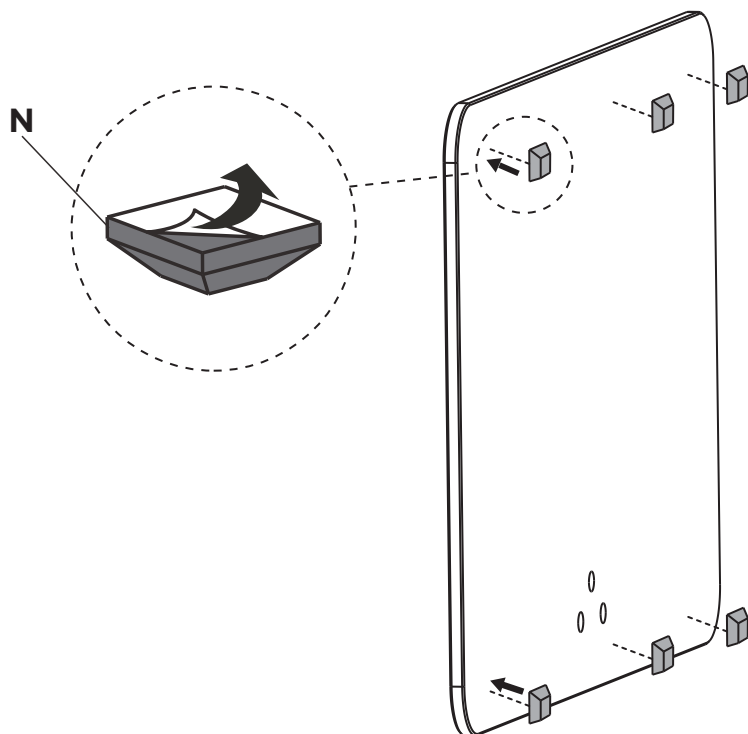

Step 2



Do not over-tighten part **P**.
Part **J** and **V** must be installed
in correct order shown on the diagram.

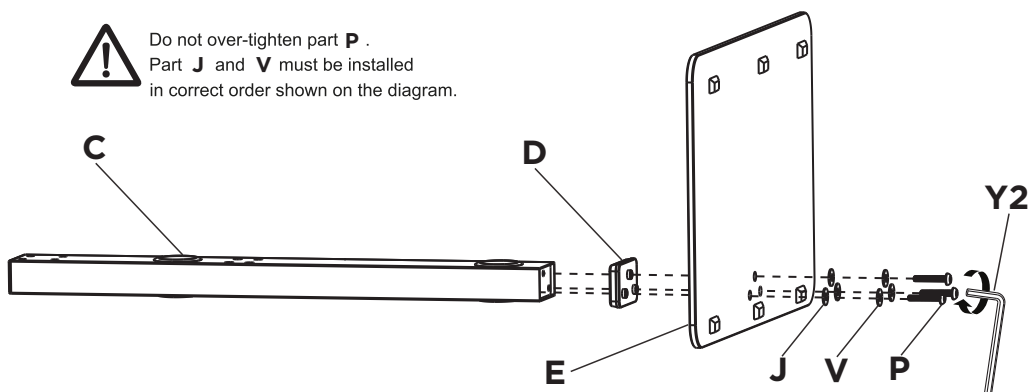

Step 3

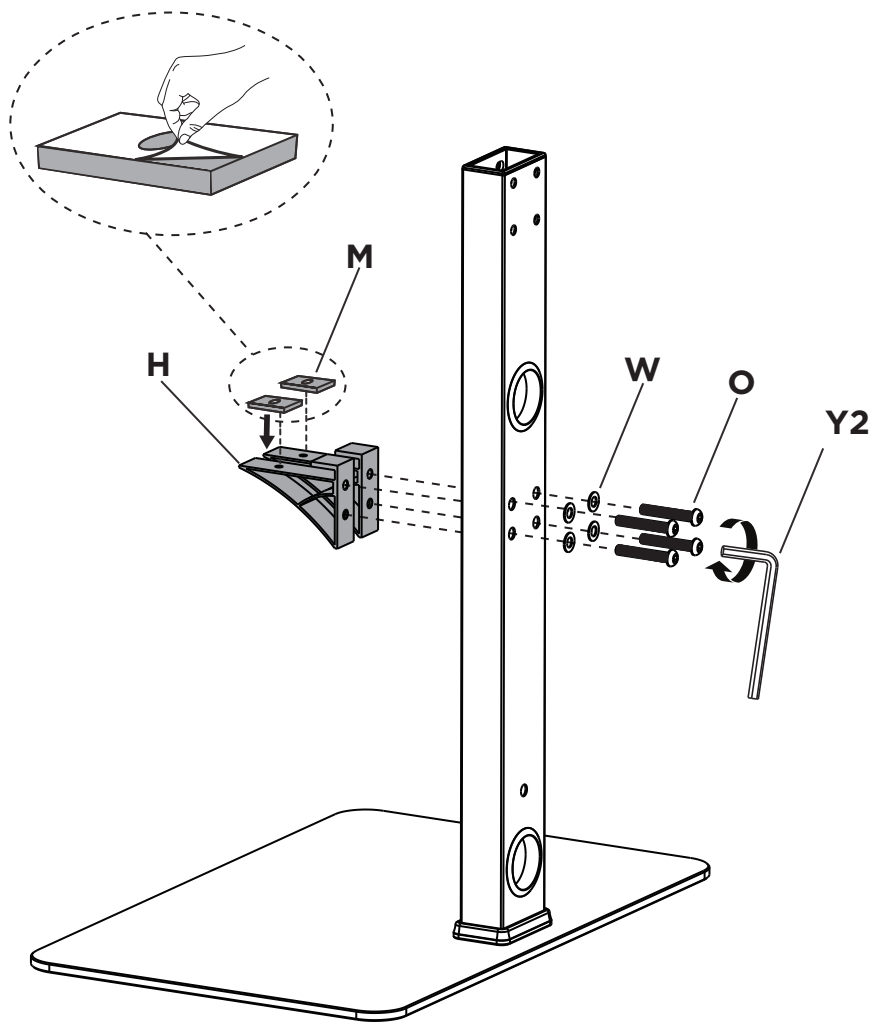

Step 4

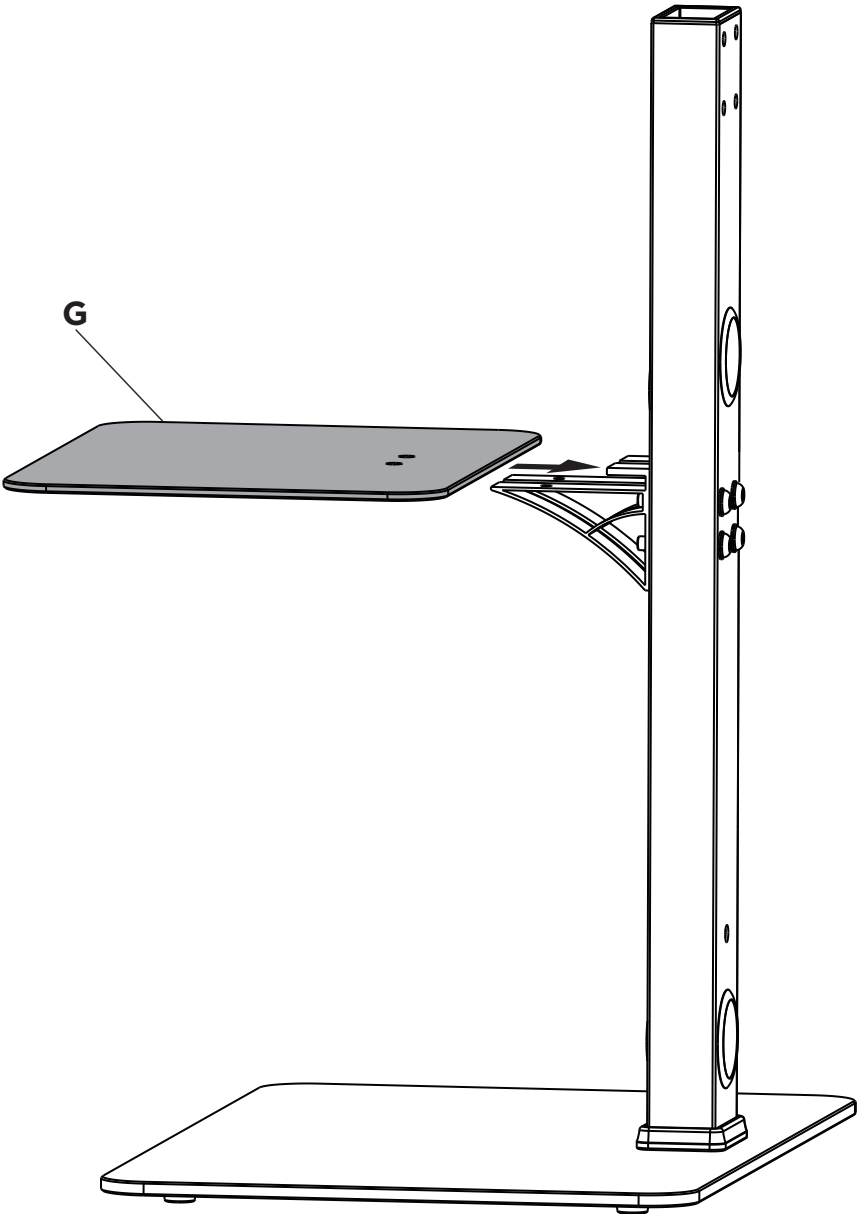

Step 5

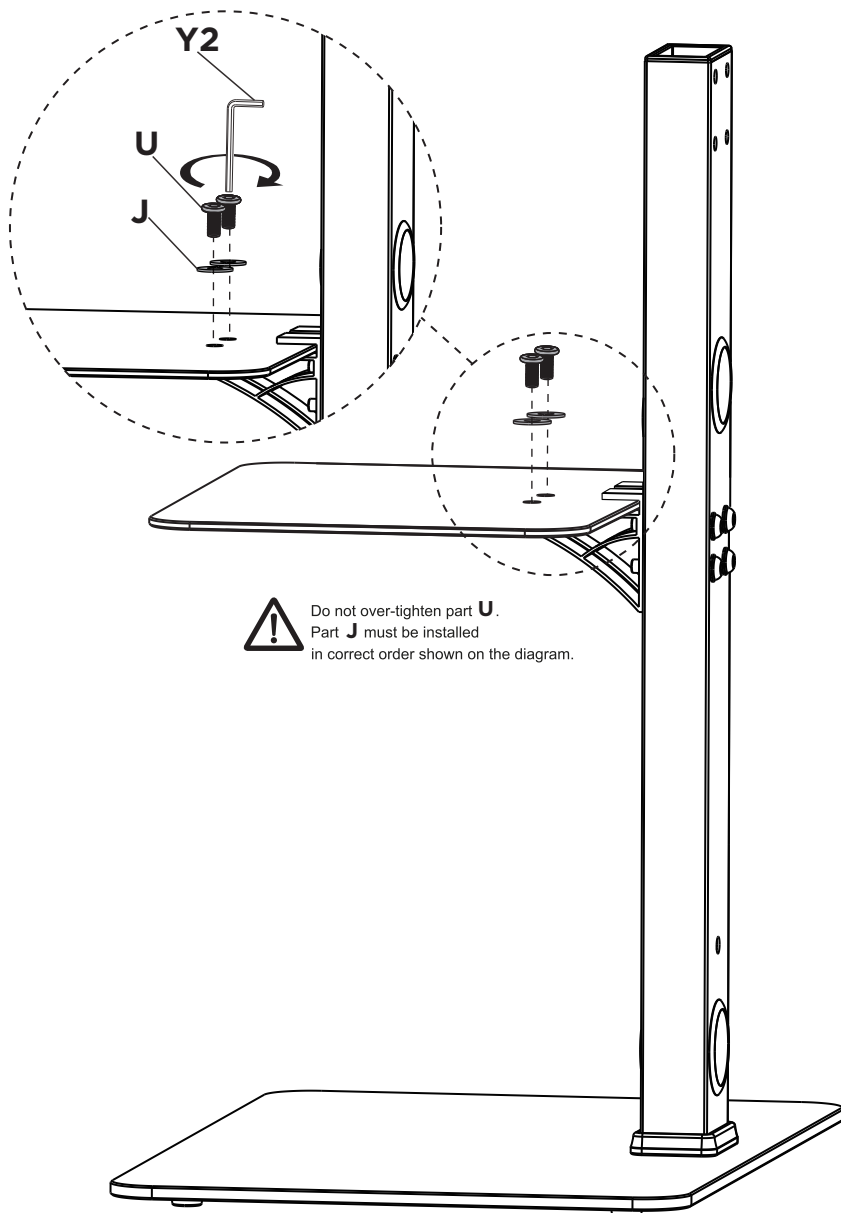

Step 6

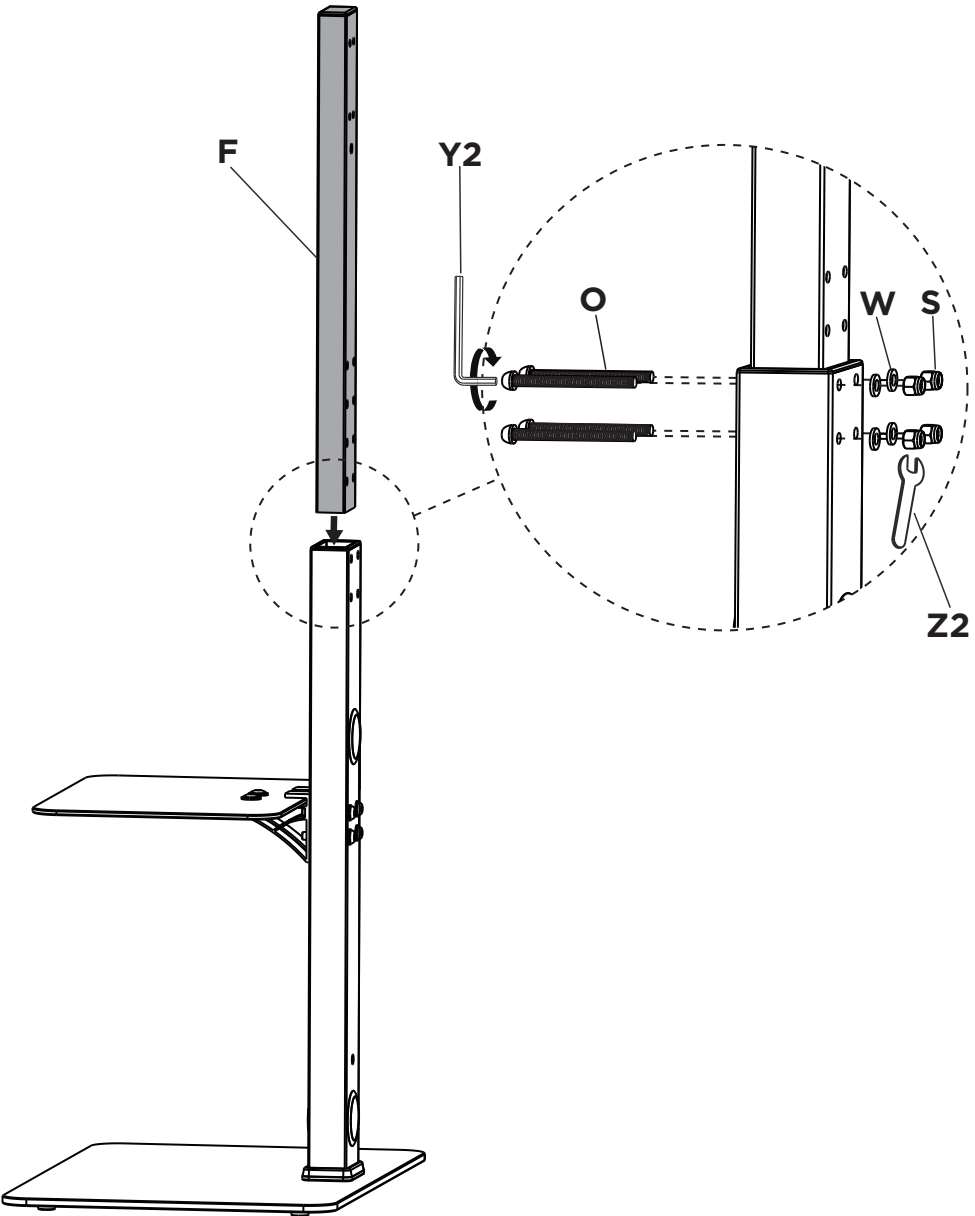

Step 7

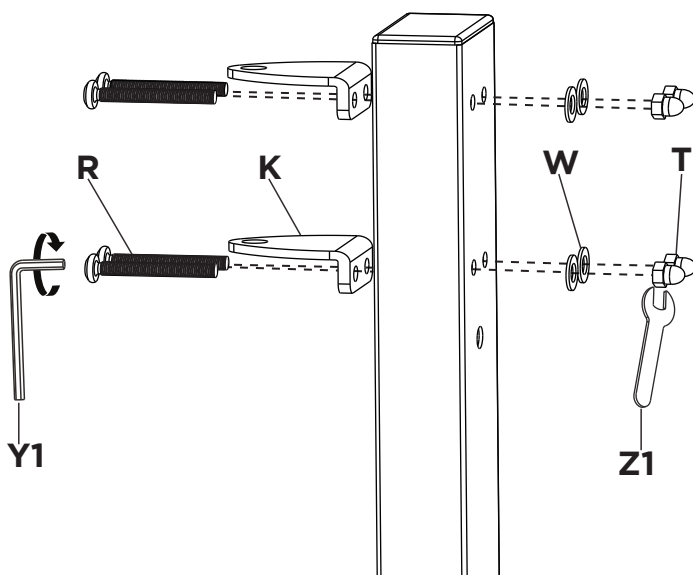

Step 8

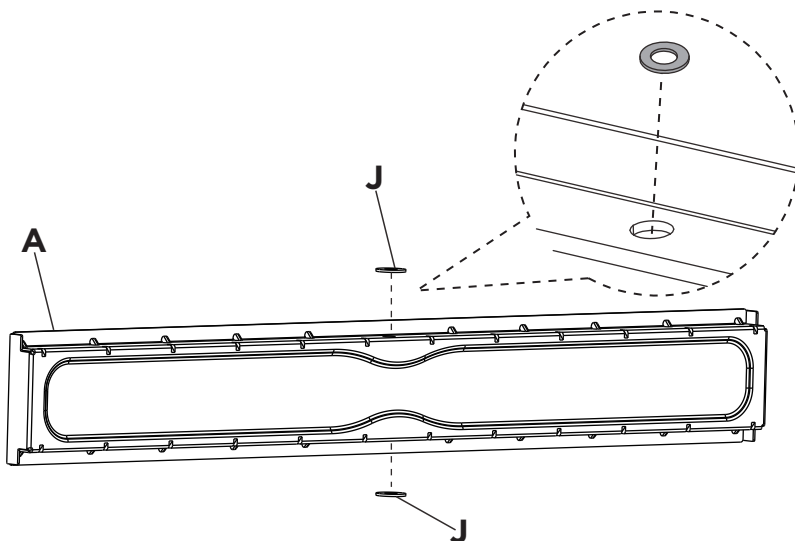

Step 9

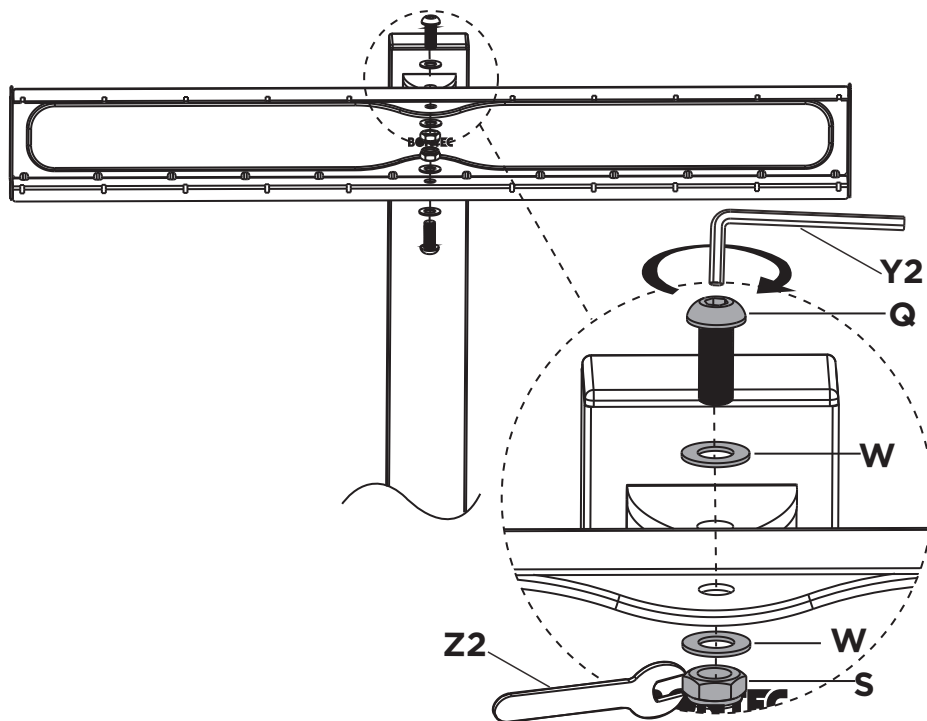

Step 10

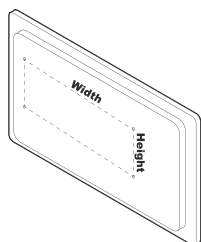

Measure the distance between the holes located at the back of your TV (these measures may form the shape of a square, or a rectangle) and check that these taken measures are within the VESA(*) range for this wall mount.
 (*) VESA: International standard established by the TV manufacturers used to determine if LCD / LED TVs are compatible with wall mounts.

75 mm ≈ 2 7/8 in	100 mm ≈ 4 in
200 mm ≈ 7 7/8 in	300 mm ≈ 11 3/4 in
400 mm ≈ 15 3/4 in	

Check TV screws

Please select the proper screw length for your TV by hand tightening to check your flat panel thread depth.

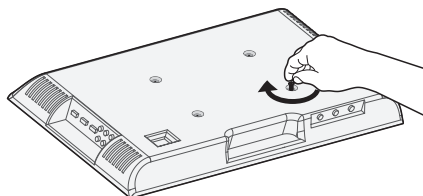

Bolt length: Verify adequate thread engagement with bolts or bolts/spacers combination.

We recommend thread engagement by at least 5 turns.

- Too short will not hold the monitor.
- Too long will damage the monitor.



Too Short



Too Long



Correct



Correct

Step 11

Mounting the Monitor Bracket to a TV

First of all, make sure the diameter of the Bolt(**W-A** to **W-F**) your TV requires. Once you have determined the correct diameter, please see the diagram as below. You will thread the Bolt into the TV using the correct Washer(**W-G**), and using the spacer(**W-H,W-I**) if necessary. Please make sure the Monitor Brackets are vertically centered and level with each other.

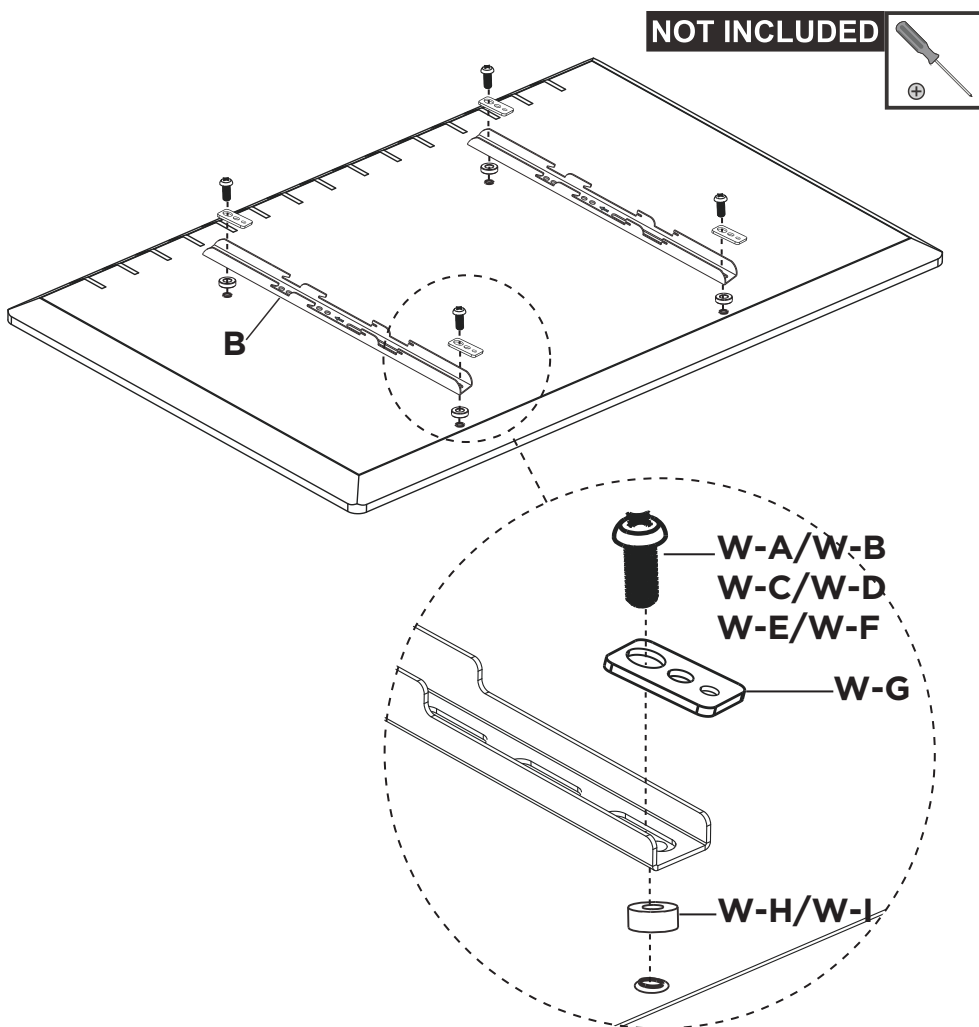

Step 12

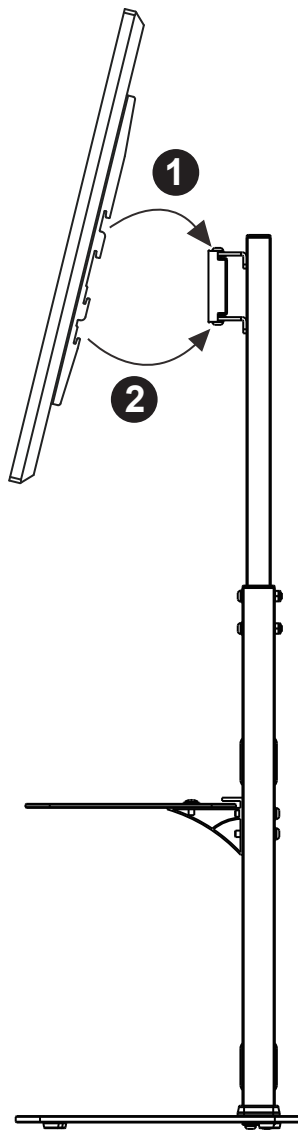

Hang the TV onto Stand, there are two gears
that can be adjusted!

Step 13

NOT INCLUDED

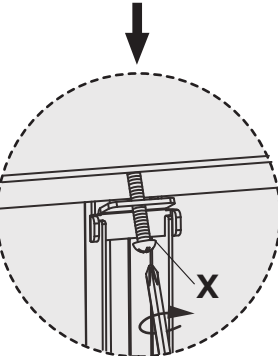
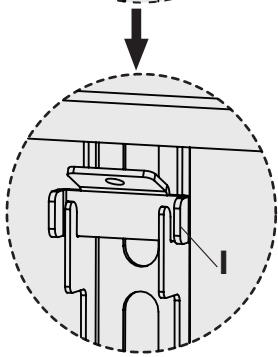
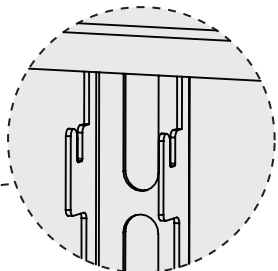
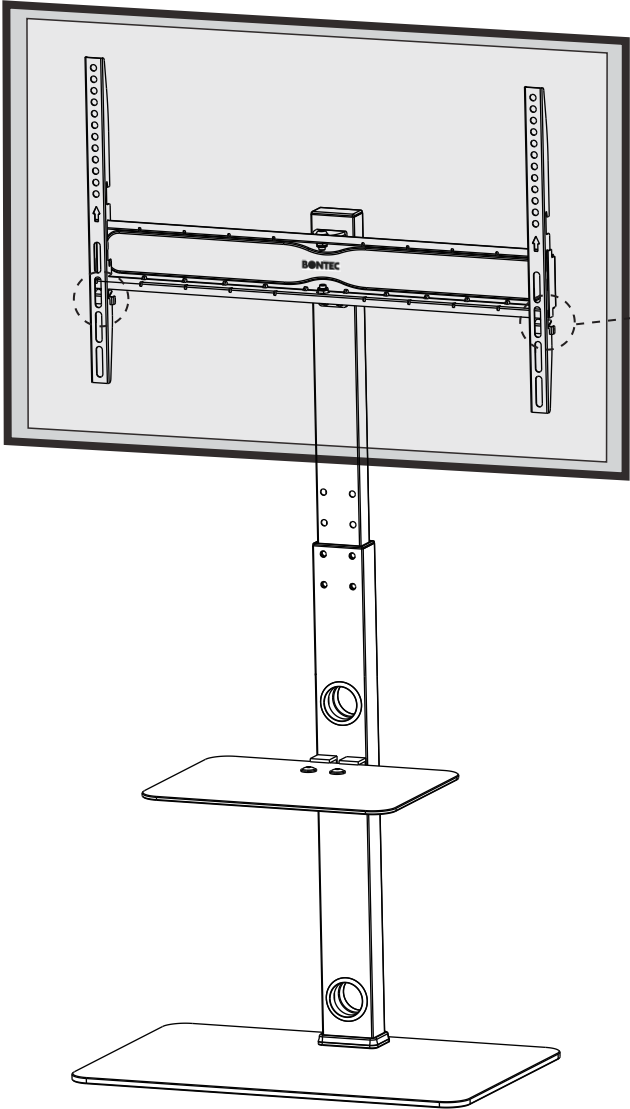

Step 14

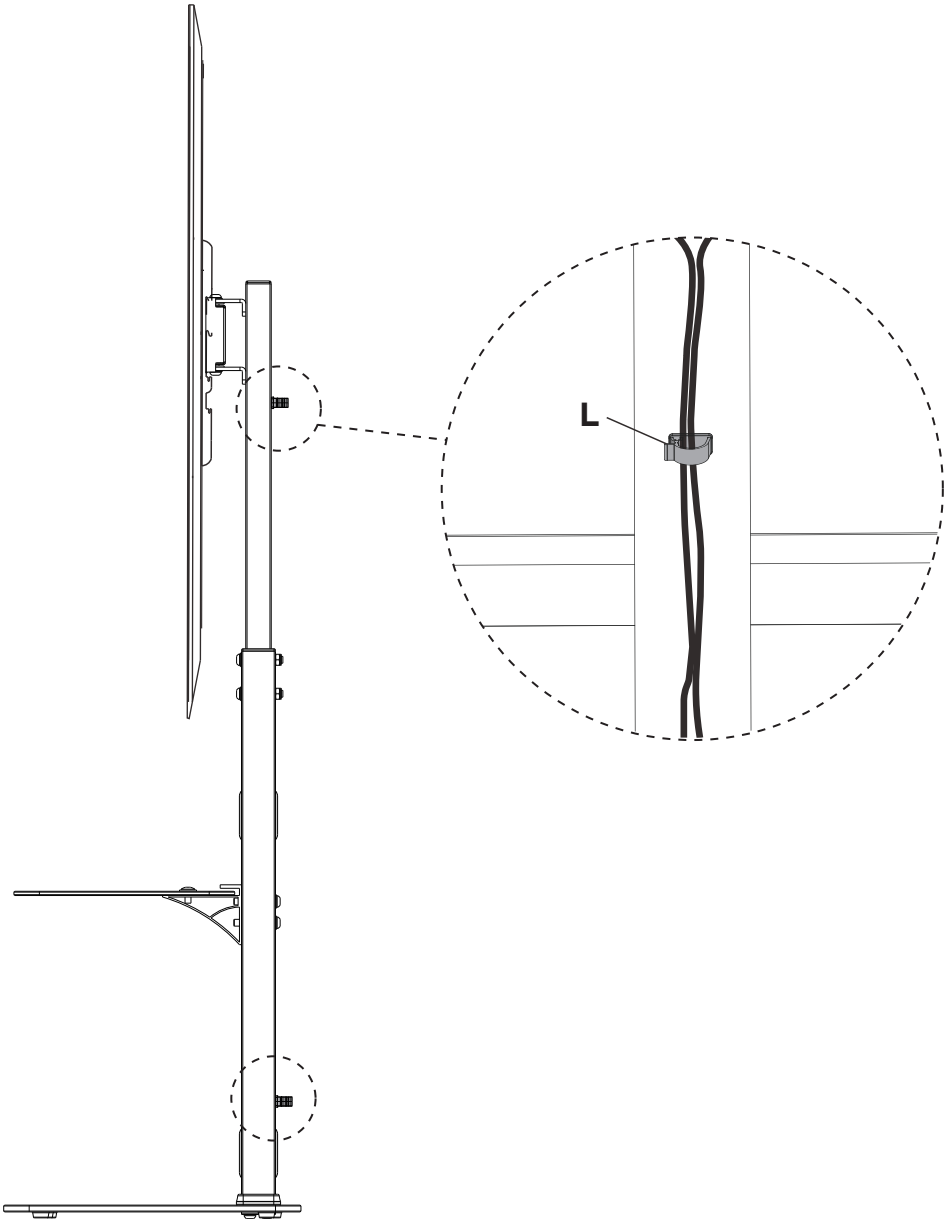

Step 15

